



**Benton Crescent | Walsall | WS3 3AH**

**£210,000**

**Webb's**  
estate agents

## Summary

**\*\* WELL MAINTAINED THREE BEDROOM SEMI DETACHED HOME \*\* SPACIOUS ACCOMMODATION \*\* PRIVATE REAR GARDEN \*\* THREE GOOD SIZED BEDROOMS \*\* MODERN FIRST FLOOR BATHROOM WC \*\* LIVING ROOM \*\* KITCHEN DINER \*\* UTILITY ROOM \*\* DRIVEWAY \*\* POPULAR AND CONVENIENT LOCATION \*\* DOUBLE GLAZING AND GAS CENTRAL HEATING \*\***

Webbs Estate Agents are pleased to bring to market this improved semi detached home situated in a popular and convenient location close to schools, amenities and shops. In brief this home offers: driveway to the front, the ground floor has an entrance hall, living room, fitted kitchen diner, utility room, On the first floor there are three generous bedrooms and modern family bathroom. There is a driveway for 3 cars and to the rear is a private and enclosed rear garden . Call us today to view this immaculately presented family home on 01922 663399

## Key Features

- SPACIOUS SEMI DETACHED PROPERTY
- THREE GOOD SIZED BEDROOMS
- GENEROUS LIVING ROOM
- MODERN BATHROOM WC
- PRIVATE REAR GARDEN
- CONVENIENT AND POPULAR LOCATION
- POPULAR AND CONVENIENT LOCATION
- MODERN KITCHEN DINER AND UTILITY ROOM
- FRONT DRIVEWAY AND PARKING FOR 3 CARS

## Rooms and Dimensions

### Reception hall

### Kitchen

13'7" x 9'10" (4.16m x 3.02m)

### Utility room

10'0" x 4'11" (3.05m x 1.51m)

### Living room

15'10" x 9'10" (4.84m x 3.02m)

### First floor landing

### Bedroom one

13'9" x 8'11" (4.21m x 2.74m)

### Bedroom two

10'2" x 10'5" (3.10m x 3.18m)

### Bedroom three

9'11" x 6'10" (3.03m x 2.10m)

### Bathroom WC

### Driveway to fore

### Private rear garden with outbuilding

### Identification Checks





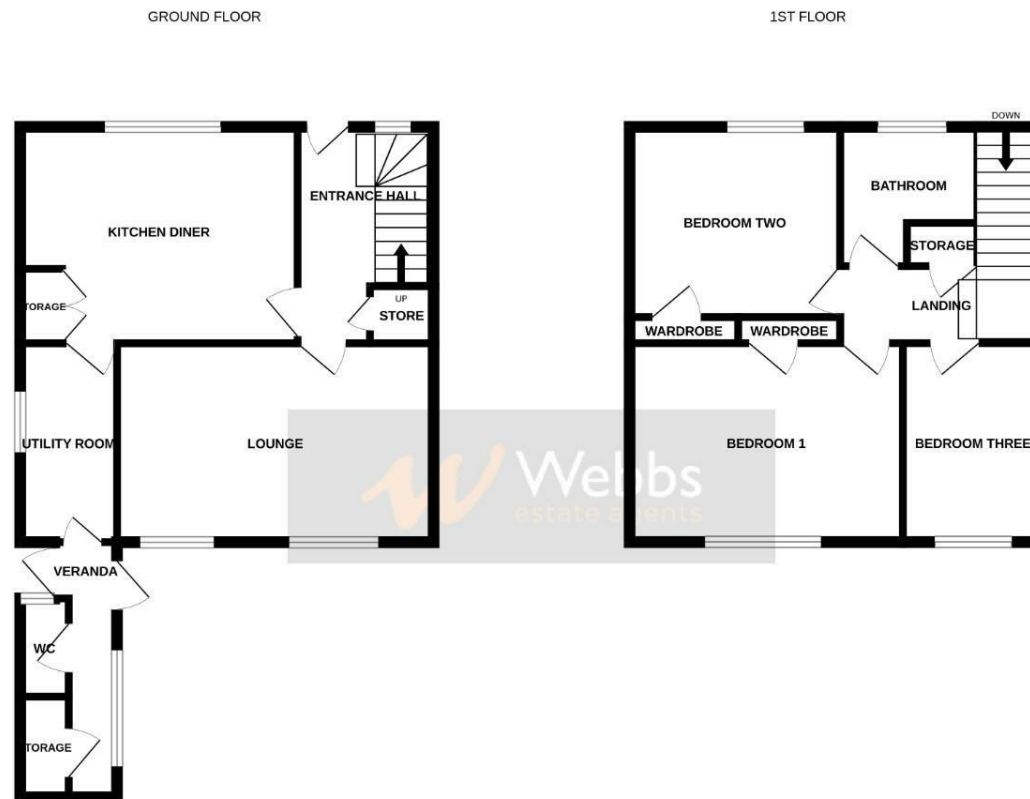

Whilst every attempt has been made to ensure the accuracy of the floorplan contained here, measurements of doors, windows, rooms and any other items are approximate and no responsibility is taken for any error, omission or mis-statement. This plan is for illustrative purposes only and should be used as such by any prospective purchaser. The services, systems and appliances shown have not been tested and no guarantee as to their operability or efficiency can be given.  
Made with Metropix ©2025

Webbs Estate Agents - endeavour to maintain accurate depictions of properties in Virtual Tours, Floor Plans and descriptions, however, these are intended only as a guide and purchasers must satisfy themselves by personal inspection.

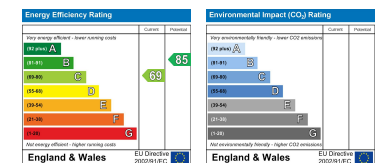

212 High Street, Bloxwich, Walsall, WS3 3LA

Tel: 01922 663399 | Email: [bloxwich@webbestateagents.co.uk](mailto:bloxwich@webbestateagents.co.uk) | [www.webbestateagents.co.uk](http://www.webbestateagents.co.uk)

